

# Valves, Fittings and Tubings

Pressure to 30,000, 40,000 and 60,000 psi



## YDB VALVES LLP

- Competitive Price
- Better Product Flexibility
- Consistency & Optimum Service

*Innovations designed to improve operations and profitability*



## Our Company

YDB VALVES LLP, a pioneer manufacturing company having good experience in the designing and manufacturing of a new concept instrumentation Valves: Manifolds, Monoflanges, SBB & DBB Valves both in needle and ball types, Floating and Trunnion design Ball Valves, strictly produced in according to the most stringent quality standards of safety and efficiency.

We have a fully well-equipped modern in-house manufacturing facility using CNC lathes, VMC, etc. with highly motivated team and up to date technology assisting us to achieve reliable products at competitive price with better product flexibility, consistency and optimum service.

Our experience in the understanding of applications requirements, combined with our high flexibility, allows us to develop customized solutions designed for customers' specific needs.

Our products are machined from the materials CF8M, SS316, SS316L, Duplex, Super Duplex, Monel, Inconel, etc.

Moreover, our valves production can be completed with complementary accessories, something that makes YDB VALVES a favourite and reliable partner for those companies that supply 'packages' of various matching goods. Our products are widely use in the Chemical, Petrochemical, Oil & Gas, Off-Shore, On-Shore, Power Generation, Naval industries, etc., used as components of plants and machineries with a high technological value.

## High Pressure Needle Valves- 30,000 psi

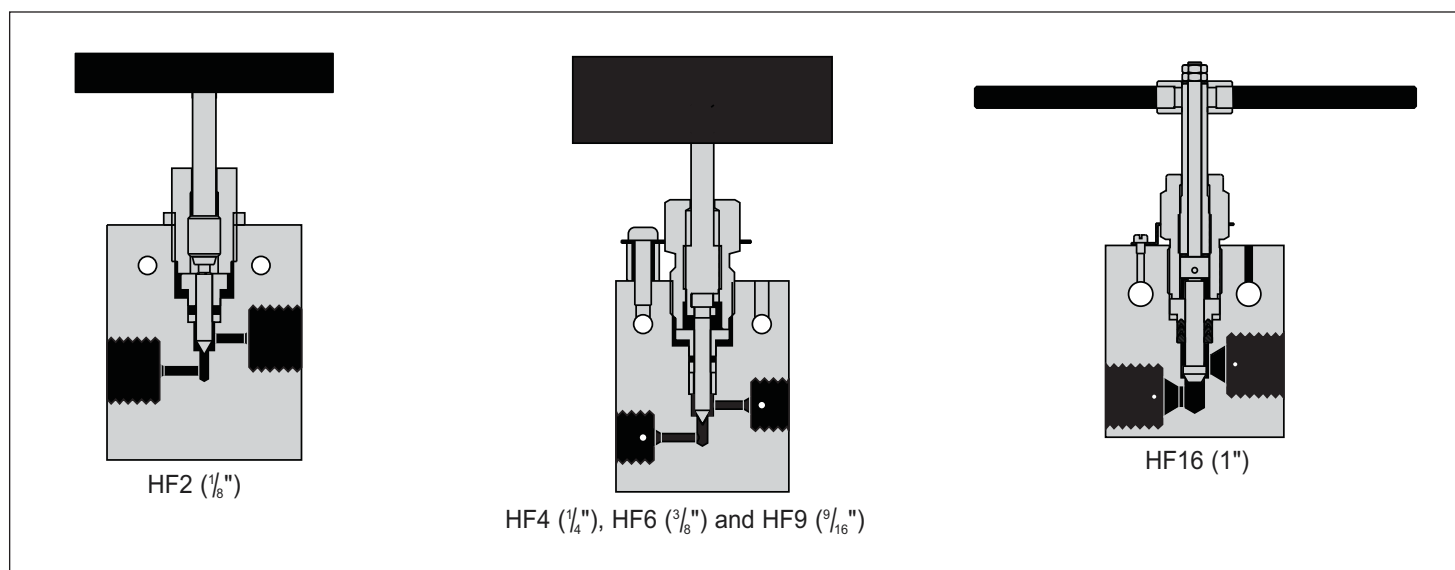

### 30,000 psi High Pressure Valves

**High Pressure (coned & threaded)** type connections for  $\frac{1}{8}$ ",  $\frac{1}{4}$ ",  $\frac{3}{8}$ ",  $\frac{9}{16}$ " and 1" O.D. tubing.

**Non-rotating tip stems** are standard for on-off service and ensure long life on valve seats. Regulating tip stems are available for all valves at no additional cost, add - REG to part number.

**Glands and collars** for tubing are supplied with each valve unless otherwise requested

**Materials** include high tensile type 316 stainless steel bodies and hardened 17-4PH stainless steel lower section stems.

**Packing** is Teflon (450°F) standard with optional Viton (350°F), BUNA-N (200°F) and Grafoil (800°F) available at no additional cost.

**Air operators** for remote control operation are available for all valves.

**Extreme temperatures** can be accommodated using extended stuffing boxes. These are available for all sizes except 1/8 tubing.

### Valve Features

- Non-rotating stem tips
- Packing below stem threads
- Type 316 ss high tensile bodies
- Positive gland lock device
- No stem adjustment needed
- Black T-handles or choice of 4 colors
- Tube sizes  $\frac{1}{8}$ " through 1"

## High Pressure Needle Valves- 30,000 psi

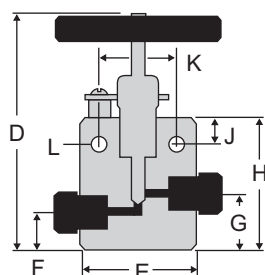

### Two Way Straight Valves

Tubing	PSI	Connection	orifice	D	E	F	G	H	J	K	L	Thk	PART NO.
1/8" O.D.	30,000	HF2	1/16"	3-1/4"	1-1/2"	11/16"	15/16"	1-13/16"	5/16"	7/8"	9/64"	3/4"	HPNV-30K-2T
1/4" O.D.	30,000	HF4	3/32"	5-3/16"	2"	5/8"	1"	2-7/16"	1/2"	1-3/8"	7/32"	1"	HPNV-30K-4T
3/8" O.D.	30,000	HF6	1/8"	5-3/16"	2"	5/8"	1"	2-7/16"	1/2"	1-3/8"	7/32"	1"	HPNV-30K-6T
9/16" O.D.	30,000	HF9	1/8"	5-5/8"	2-5/8"	1"	1-7/16"	2-7/8"	1/2"	1-3/8"	7/32"	1 1/2"	HPNV-30K-9T
1" O.D.	30,000	HF16	7/16"	8-3/8"	4-1/8"	15/16"	1-11/16"	4-7/16"	1-1/8"	2-1/2"	9/16"	1 3/4"	HPNV-30K-16T

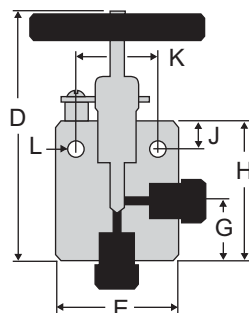

### Two Way Angle Valves

Tubing	PSI	Connection	orifice	D	E	F	G	H	J	K	L	Thk	PART NO.
1/8" O.D.	30,000	HF2	1/16"	3-1/4"	1-1/2"	-	15/16"	1-13/16"	5/16"	7/8"	9/64"	3/4"	HPANV-30K-2T
1/4" O.D.	30,000	HF4	3/32"	5-3/16"	2"	-	1"	2-7/16"	1/2"	1-3/8"	7/32"	1"	HPANV-30K-4T
3/8" O.D.	30,000	HF6	1/8"	5-9/16"	2"	-	1 3/8"	2-13/16"	1/2"	1-3/8"	7/32"	1"	HPANV-30K-6T
9/16" O.D.	30,000	HF9	1/8"	5-5/8"	2-5/8"	-	1-7/16"	2-7/8"	1/2"	1-3/8"	7/32"	1 1/2"	HPANV-30K-9T
1" O.D.	30,000	HF16	7/16"	9-3/8"	4-1/8"	-	2-3/8"	5-1/8"	1-1/8"	2-1/2"	9/16"	1 3/4"	HPANV-30K-16T

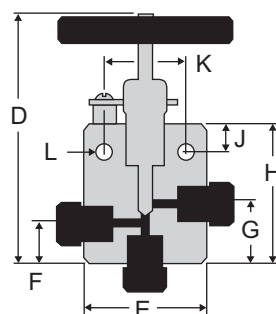

### Three Way Valves / Two Pressure Connections

Tubing	PSI	Connection	orifice	D	E	F	G	H	J	K	L	Thk	PART NO.
1/8" O.D.	30,000	HF2	1/16"	3-1/4"	1-1/2"	11/16"	15/16"	1-13/16"	5/16"	7/8"	9/64"	3/4"	HP3NV2-30K-2T
1/4" O.D.	30,000	HF4	3/32"	5-3/16"	2"	5/8"	1"	2-7/16"	1/2"	1-3/8"	7/32"	1"	HP3NV2-30K-4T
3/8" O.D.	30,000	HF6	1/8"	5-9/16"	2"	1"	1 3/8"	2-13/16"	1/2"	1-3/8"	7/32"	1"	HP3NV2-30K-6T
9/16" O.D.	30,000	HF9	1/8"	6-1/16"	2-5/8"	1-7/16"	1-7/8"	3-5/16"	1/2"	1-3/8"	7/32"	1 1/2"	HP3NV2-30K-9T
1" O.D.	30,000	HF16	7/16"	9-3/4"	4-1/8"	2-3/8"	2-13/16"	5-9/16"	1-1/8"	2-1/2"	9/16"	1 3/4"	HP3NV2-30K-16T

# High Pressure Needle Valves- 30,000 psi

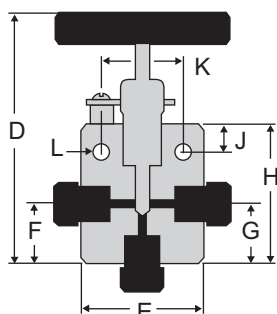

**Three Way Valves  
One Pressure Connection**

Tubing	PSI	Connection	orifice	D	E	F	G	H	J	K	L	Thk	PART NO.
1/8" O.D.	30,000	HF2	1/16"	3-1/4"	1-1/2"	15/16"	15/16"	1-13/16"	5/16"	7/8"	9/64"	3/4"	HP3NV1-30K-2T
1/4" O.D.	30,000	HF4	3/32"	5-3/8"	2"	1"	1"	2-7/16"	1/2"	1-3/8"	7/32"	1"	HP3NV1-30K-4T
3/8" O.D.	30,000	HF6	1/8"	5-9/8"	2"	2"	1-7/16"	2-13/16"	1/2"	1-3/8"	7/32"	1"	HP3NV1-30K-6T
9/16" O.D.	30,000	HF9	1/8"	5-5/8"	2-5/8"	2-3/16"	1-7/16"	2-7/8"	1/2"	1-3/8"	7/32"	1 1/2"	HP3NV1-30K-9T
1" O.D.	30,000	HF16	7/16"	9-1/4"	4-1/8"	2-3/8"	2-3/8"	5-1/8"	1-1/8"	2-1/2"	9/16"	1 3/4"	HP3NV1-30K-16T

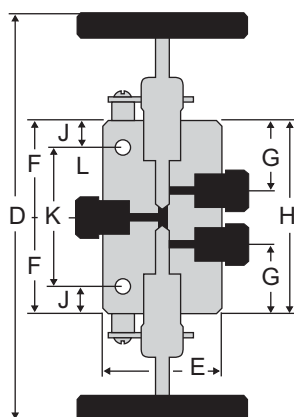

**Three Way / Two Stem  
Connection Valves**

Tubing	PSI	Connection	orifice	D	E	F	G	H	J	K	L	Thk	PART NO.
1/8" O.D.	30,000	HF2	1/16"	5-1/4"	1-1/2"	15/16"	7/8"	2-1/2"	5/16"	1-7/8"	9/64"	3/4"	HP32NV-30K-2T
1/4" O.D.	30,000	HF4	3/32"	9-1/4"	2"	1"	1-7/16"	3-3/4"	1/2"	2-3/4"	7/32"	1"	HP32NV-30K-4T
3/8" O.D.	30,000	HF6	1/8"	9-1/2"	2"	2"	1-7/16"	4"	1/2"	3"	7/32"	1"	HP32NV-30K-6T
9/16" O.D.	30,000	HF9	1/8"	9-7/8"	2-5/8"	2-3/16"	1-7/16"	4-3/8"	1/2"	3-3/8"	7/32"	1 1/2"	HP32NV-30K-9T
1" O.D.	30,000	HF16	7/16"	11-7/8"	4-1/8"	3-7/8"	2-3/4"	7-3/4"	1-1/8"	2-1/2"	9/16"	1 3/4"	HP32NV-30K-16T

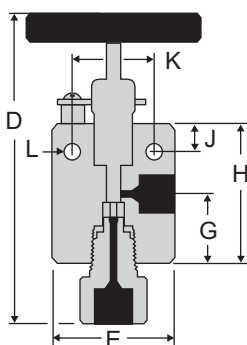

**Replaceable Seat Valves**

Tubing	PSI	Connection	orifice	D	E	F	G	H	J	K	L	Thk	PART NO.
1/4" O.D.	30,000	HF4	3/32"	6"	2"	-	1"	2-7/16"	1/2"	1-3/8"	7/32"	1"	HPNVR-30K-4T
3/8" O.D.	30,000	HF6	1/8"	6-5/8"	2"	-	1-3/8"	2-13/16"	1/2"	1-3/8"	7/32"	1"	HPNVR-30K-6T
9/16" O.D.	30,000	HF9	1/8"	6-7/8"	2-5/8"	-	1-7/16"	2-7/8"	1/2"	1-3/8"	7/32"	1 1/2"	HPNVR-30K-9T
1" O.D.	30,000	HF16	7/16"	10-7/8"	4-1/8"	-	2-3/8"	5-1/8"	1-1/8"	2-1/2"	9/16"	1 3/4"	HPNVR-30K-16T

## High Pressure Needle Valves- 40,000 psi

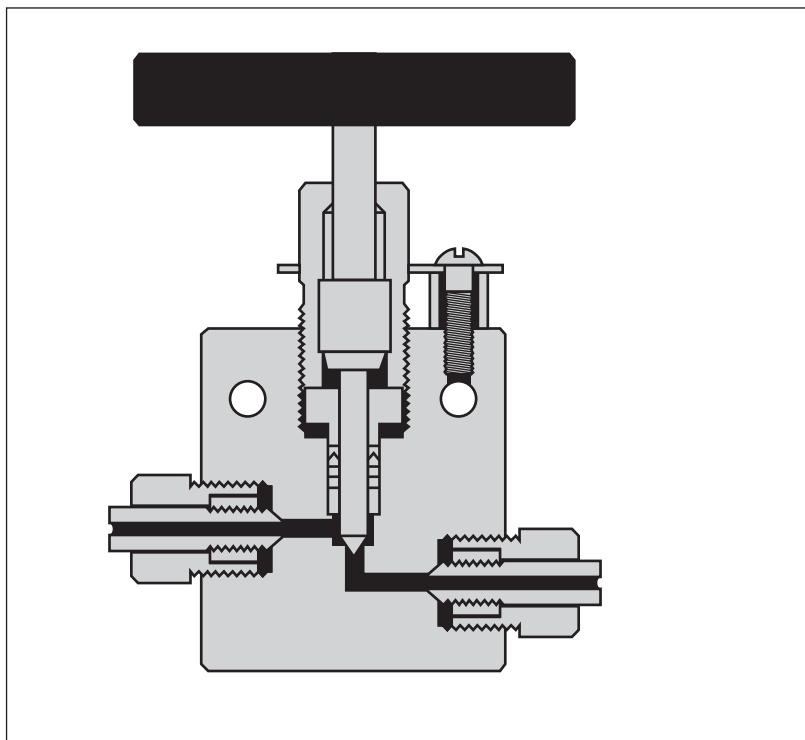

### 40,000 psi High Pressure Valves

**High Pressure (coned & threaded)** type connections for  $\frac{9}{16}$ " O.D. tubing.

**Non-rotating tip stems** are standard for on-off service and ensure long life on valve seats. Regulating tip stems are available for all valves at no additional cost, add - REG to part number.

**Glands and collars** for tubing are supplied with each valve unless otherwise requested .

**Materials** include high tensile type 316 stainless steel bodies and hardened 17-4PH stainless steel lower section stems.

**Packing set** consists of multiple Teflon packing with nylon back up, with optional Viton (350°F), BUNA-N (200°F) and Grafoil (800°F) available at no additional cost.

**Air operators** for remote control operation are available for all valves.

**Extreme temperatures** can be accommodated using extended stuffing boxes .

### Valve Features

- Non-rotating stem tips
- Packing below stem threads
- Type 316 ss high tensile bodies
- Positive gland lock device
- No stem adjustment needed
- Black T-handles or choice of 4 colors



## High Pressure Needle Valves- 40,000 psi

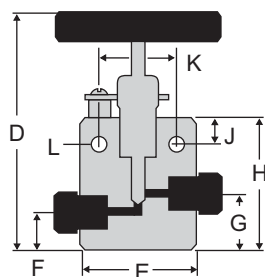

### Two Way Straight Valves

Tubing	PSI	Connection	orifice	D	E	F	G	H	J	K	L	Thk	PART NO.
9/16" O.D.	40,000	HF9	1/8"	5-5/8"	2-5/8"	1"	1-7/16"	2-7/8"	1/2"	1-5/8"	7/32"	1-1/2"	HPNV-40K-9T

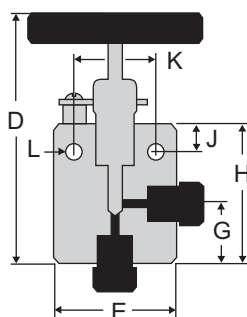

### Two Way Angle Valves

Tubing	PSI	Connection	orifice	D	E	F	G	H	J	K	L	Thk	PART NO.
9/16" O.D.	40,000	HF9	1/8"	5-5/8"	2-5/8"	-	1-7/16"	2-7/8"	1/2"	1-5/8"	7/32"	1-1/2"	HPANV-40K-9T

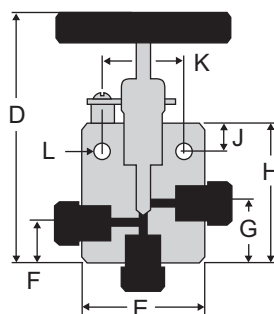

### Three Way Valves / Two Pressure Connections

Tubing	PSI	Connection	orifice	D	E	F	G	H	J	K	L	Thk	PART NO.
9/16" O.D.	40,000	Hf9	1/8"	6-1/4"	2-5/8"	1-7/16"	1-7/8"	3-5/16"	1/2"	1-5/8"	7/32"	1-1/2"	HP3NV2-40K-9T

## High Pressure Needle Valves- 40,000 psi

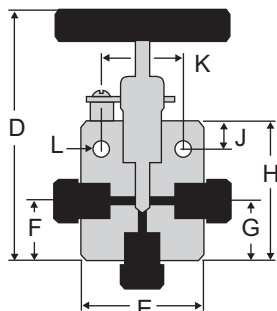

### Three Way Valves One Pressure Connection

Tubing	PSI	Connection	orifice	D	E	F	G	H	J	K	L	Thk	PART NO.
9/16" O.D.	40,000	HF9	1/8"	5-5/8"	2-5/8"	1-7/16"	1-7/16"	2-7/8"	1/2"	1-5/8"	7/32"	1-1/2"	HP3NV1-40K-9T

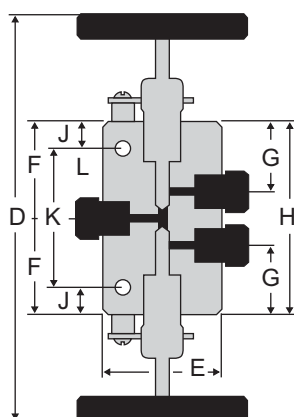

### Three Way / Two Stem Connection Valves

Tubing	PSI	Connection	orifice	D	E	F	G	H	J	K	L	Thk	PART NO.
9/16" O.D.	40,000	HF9	1/8"	9-7/8"	2-5/8"	2-3/16"	1-7/16"	4-3/8"	1/2"	3-3/8"	7/32"	1-1/2"	HP32NV-40K-9T

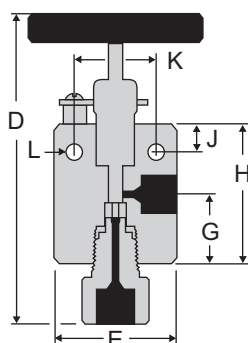

### Replaceable Seat Valves

Tubing	PSI	Connection	orifice	D	E	F	G	H	J	K	L	Thk	PART NO.
9/16" O.D.	40,000	HF9	1/8"	6-3/8"	2-5/8"	-	1-7/16"	2-7/8"	1/2"	1-5/8"	7/32"	1-1/2"	HPNVR-40K-9T



## High Pressure Needle Valves- 60,000 psi

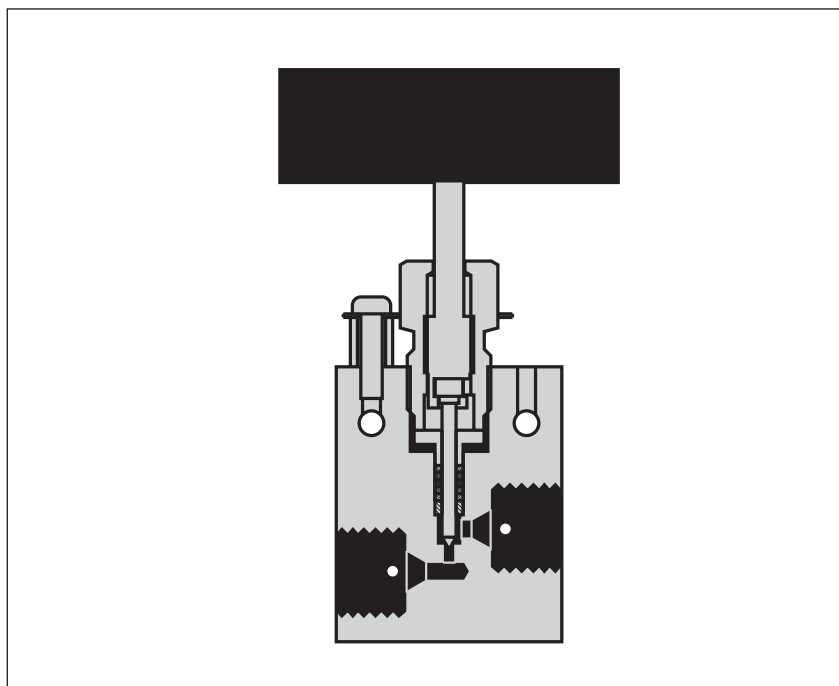

### 60,000 psi High Pressure Valves

**High Pressure (coned & threaded)** type connections for  $\frac{1}{8}$ ",  $\frac{1}{4}$ ",  $\frac{3}{8}$ ",  $\frac{9}{16}$ " and 1" O.D. tubing.

**Non-rotating tip stems** are standard for on-off service and ensure long life on valve seats. Regulating tip stems are available for all valves at no additional cost, add - REG to part number.

**Glands and collars** for tubing are supplied with each valve unless otherwise requested .

**Materials** include high tensile type 316 stainless steel bodies and hardened 17-4PH stainless steel lower section stems.

**Packing set** consists of multiple Teflon packing with nylon back up, with optional Viton (350°F), BUNA-N (200°F) and Grafoil (800°F) available at no additional cost.

**Air operators** for remote control operation are available for all valves.

**Extreme temperatures** can be accommodated using extended stuffing boxes . These are available for all sizes except 1/8 tubing.

### Valve Features

- Non-rotating stem tips
- Packing below stem threads
- Type 316 ss high tensile bodies
- Positive gland lock device
- No stem adjustment needed
- Black T-handles or choice of 4 colors
- Tube sizes  $\frac{1}{8}$ " through  $\frac{9}{16}$ "

## High Pressure Needle Valves- 60,000 psi

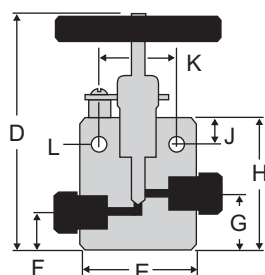

### Two Way Straight Valves

Tubing	PSI	Connection	orifice	D	E	F	G	H	J	K	L	Thk	PART NO.
1/8" O.D.	60,000	HF2	1/16"	5-3/16"	1/2"	5/8"	15/16"	2-7/16"	1/2"	1-3/8"	7/32"	1"	HPNV-60K-2T
1/4" O.D.	60,000	HF4	1/16"	5-3/16"	2"	5/8"	1"	2-7/16"	1/2"	1-3/8"	7/32"	1"	HPNV-60K-4T
3/8" O.D.	60,000	HF6	1/16"	5-3/16"	2"	5/8"	1"	2-7/16"	1/2"	1-3/8"	7/32"	1"	HPNV-60K-6T
9/16" O.D.	60,000	HF9	1/16"	5-5/8"	2-5/8"	1"	1-7/16"	2-7/8"	1/2"	1-3/8"	7/32"	1-1/2"	HPNV-60K-9T

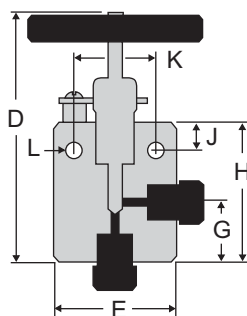

### Two Way Angle Valves

Tubing	PSI	Connection	orifice	D	E	F	G	H	J	K	L	Thk	PART NO.
1/8" O.D.	60,000	HF2	1/16"	5-3/16"	2"	-	1"	2-7/16"	1/2"	1-3/8"	7/32"	1"	HPANV-60K-2T
1/4" O.D.	60,000	HF4	1/16"	5-3/16"	2"	-	1"	2-7/16"	1/2"	1-3/8"	7/32"	1"	HPANV-60K-4T
3/8" O.D.	60,000	HF6	1/16"	5-3/8"	2"	-	1-3/8"	2-13/16"	1/2"	1-3/8"	7/32"	1"	HPANV-60K-6T
9/16" O.D.	60,000	HF9	1/16"	5-5/8"	2-5/8"	-	1-7/16"	2-7/8"	1/2"	1-3/8"	7/32"	1 1/2"	HPANV-60K-9T

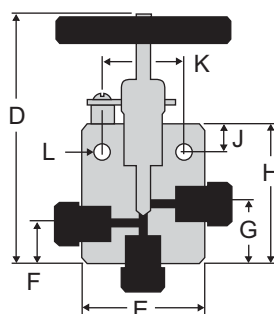

### Three Way Valves / Two Pressure Connections

Tubing	PSI	Connection	orifice	D	E	F	G	H	J	K	L	Thk	PART NO.
1/8" O.D.	60,000	HF2	1/16"	5-3/16"	2"	5/8"	1"	2-7/16"	1/2"	1-3/8"	7/32"	1"	HP3NV2-60K-2T
1/4" O.D.	60,000	Hf4	1/16"	5-3/16"	2"	5/8"	1"	2-7/16"	1/2"	1-3/8"	7/32"	1"	HP3NV2-60K-4T
3/8" O.D.	60,000	HF6	1/16"	5-9/16"	2"	5/8"	1-3/8"	2-13/16"	1/2"	1-3/8"	7/32"	1"	HP3NV2-60K-6T
9/16" O.D.	60,000	HF9	1/16"	6-1/16"	2-5/8"	1-7/16"	1-7/8"	3-5/16"	1/2"	1-3/8"	7/32"	1 1/2"	HP3NV2-60K-9T

# High Pressure Needle Valves- 60,000 psi

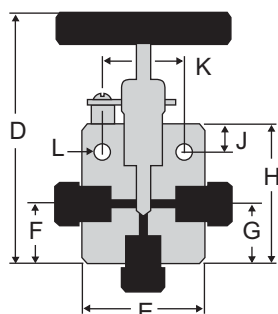

**Three Way Valves  
One Pressure Connection**

Tubing	PSI	Connection	orifice	D	E	F	G	H	J	K	L	Thk	PART NO.
1/8" O.D.	60,000	HF2	1/16"	5-3/16"	2"	7/8"	1/2"	2-7/16"	1/2"	1-3/8"	7/32"	1"	HP3NV1-60K-2T
1/4" O.D.	60,000	HF4	1/16"	5-3/16"	2"	1"	1"	2-7/16"	1/2"	1-3/8"	7/32"	1"	HP3NV1-60K-4T
3/8" O.D.	60,000	HF6	1/16"	5-9/16"	2"	1-3/8"	1-3/8"	2-13/16"	1/2"	1-3/8"	7/32"	1"	HP3NV1-60K-6T
9/16" O.D.	60,000	HF9	1/16"	5-5/8"	2-5/8"	1-7/16"	1-7/16"	2-7/8"	1/2"	1-3/8"	7/32"	1 1/2"	HP3NV1-60K-9T

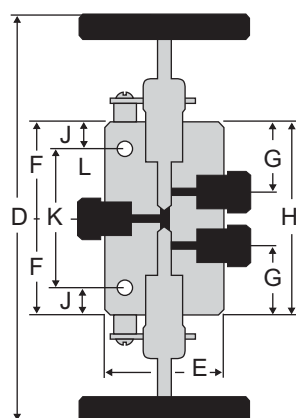

**Three Way / Two Stem  
Connection Valves**

Tubing	PSI	Connection	orifice	D	E	F	G	H	J	K	L	Thk	PART NO.
1/8" O.D.	60,000	HF2	1/16"	9-1/4"	2"	1-7/8"	1-7/16"	3-3/4"	1/2"	2-3/4"	7/64"	1"	HP32NV-60K-2T
1/4" O.D.	60,000	HF4	1/16"	9-1/4"	2"	1-7/8"	1-7/16"	3-3/4"	1/2"	2-3/4"	7/32"	1"	HP32NV-60K-4T
3/8" O.D.	60,000	HF6	1/16"	9-1/2"	2"	2"	1-7/16"	4"	1/2"	3"	7/32"	1"	HP32NV-60K-6T
9/16" O.D.	60,000	HF9	1/16"	9-7/8"	2-5/8"	2-3/16"	1-7/16"	4-3/8"	1/2"	3-3/8"	7/32"	1 1/2"	HP32NV-60K-9T

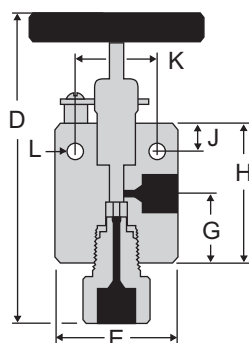

**Replaceable Seat Valves**

Tubing	PSI	Connection	orifice	D	E	F	G	H	J	K	L	Thk	PART NO.
1/4" O.D.	60,000	HF4	1/16"	6"	2"	-	1"	2-7/16"	1/2"	1-3/8"	7/32"	1"	HPNVR-60K-4T
3/8" O.D.	60,000	HF6	1/16"	6-5/8"	2"	-	1-3/8"	2-13/16"	1/2"	1-3/8"	7/32"	1"	HPNVR-60K-6T
9/16" O.D.	60,000	HF9	1/16"	6-13/16"	2-5/8"	-	1-7/16"	2-7/8"	1/2"	1-3/8"	7/32"	1 1/2"	HPNVR-60K-9T

## High Pressure Tubing

Tubing is cold drawn, seamless, and is supplied in the  $\frac{1}{8}$ " hard condition (not annealed). Tensile strength is approximately 40 percent higher than that of annealed tubing. All tubing is manufactured in strict accordance with High Pressure Equipment Company specifications to insure tolerances and bore quality. Tubing is stocked in lengths of 18 to 22 feet but may be ordered in shorter lengths with **no additional cutting charge**.

**Note:** The  $\frac{1}{8}$ " O.D. tubing sizes may be coiled for shipment. Larger sizes must be shipped in straight lengths.

	Tubing size	Working pressure psi	Type of connection used	Material	Catalog Order Number
<b>1/8"</b>	1/8" O.D. x 0.020" I.D.	60,000	1/8" HIGH PRESSURE (HF2)	316 SS	
	1/8" O.D. x 0.040" I.D.	30,000	1/8" HIGH PRESSURE (HF2)	316 SS	
<b>1/4"</b>	1/4" O.D. x 0.083" I.D.	60,000	1/4" HIGH PRESSURE (HF4)	316 SS *	
				304 SS *	
<b>3/8"</b>	3/8" O.D. x 1/8" I.D.	60,000	3/8" HIGH PRESSURE (HF6)	316 SS	
				304 SS	
<b>9/16"</b>	9/16" O.D. x 3/16" I.D.	60,000	9/16" HIGH PRESSURE (HF9)	316 SS	
				304 SS	
<b>9/16"</b>	9/16" O.D. x 1/4" I.D.	40,000	9/16" HIGH PRESSURE (HF9)	316 SS	
				304 SS	
<b>1"</b>	1" O.D. x 0.437" I.D.	30,000	1" HIGH PRESSURE (HF16)	316 SS	

## Nipples

Nipples as shown below are stocked in Types 304 and 316 Stainless Steel. Nipples in lengths other than those shown are supplied upon request. Nipples are not furnished with collars and glands, unless specified at time of order.

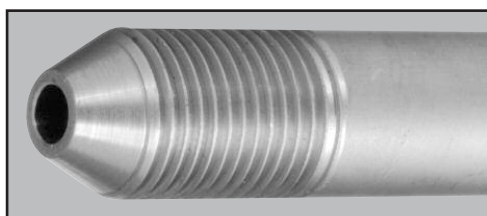

## Coned and Threaded Nipples

Length	Tubing Size (O.D. x I.D.)						
	1/8" x 0.020"	1/8" x 0.040" **	1/4" x 0.083"	3/8" x 1/8" *	9/16" x 1/4" *	9/16" x 3/16" *	1" x 0.437" **
<b>psi</b>	60,000 psi	30,000 psi	60,000 psi	60,000 psi	40,000 psi	60,000 psi	30,000 psi
2"	60-HM2-2	30-HM2-2					
2 3/4"			60-HM4-2.75				
3"	60-HM2-3	30-HM2-3		60-HM6-3			
4"	60-HM2-4	30-HM2-4			40-HM9-4	60-HM9-4	
6"	60-HM2-6	30-HM2-6	60-HM4-6	60-HM6-6	40-HM9-6	60-HM9-6	30-HM16-6
8"			60-HM4-8	60-HM6-8	40-HM9-8	60-HM9-8	30-HM16-8
9"	60-HM2-9	30-HM2-9					
10"			60-HM4-10	60-HM6-10	40-HM9-10	60-HM9-10	30-HM16-10
12"	60-HM2-12	30-HM2-12	60-HM4-12	60-HM6-12	40-HM9-12	60-HM9-12	30-HM16-12



# YDB VALVES LLP

An ISO 9001:2015 Certified Manufacturing Co.

## Head Office :

Y-21, Khan Real Industrial Estate,  
N. H. 08, Pelhar, Vasai Phata,  
Vasai East, Palghar - 401208.  
INDIA.

Contact us: +91- 80 8701 0270

Write us: [info@ydbvalves.com](mailto:info@ydbvalves.com)

Website : [www.ydbvalves.com](http://www.ydbvalves.com)